

Review the Plan

I have found it interesting to review the floor plan and architectural drawing again as the actual build is underway. Thought you might like to have a look too. First, here is the drawing. This is the view one will have when approaching the “T” where you must either turn west to the Nursing Home and Pineview Manor or to the east towards the Youth Farm Bible Camp and Country Gardens:

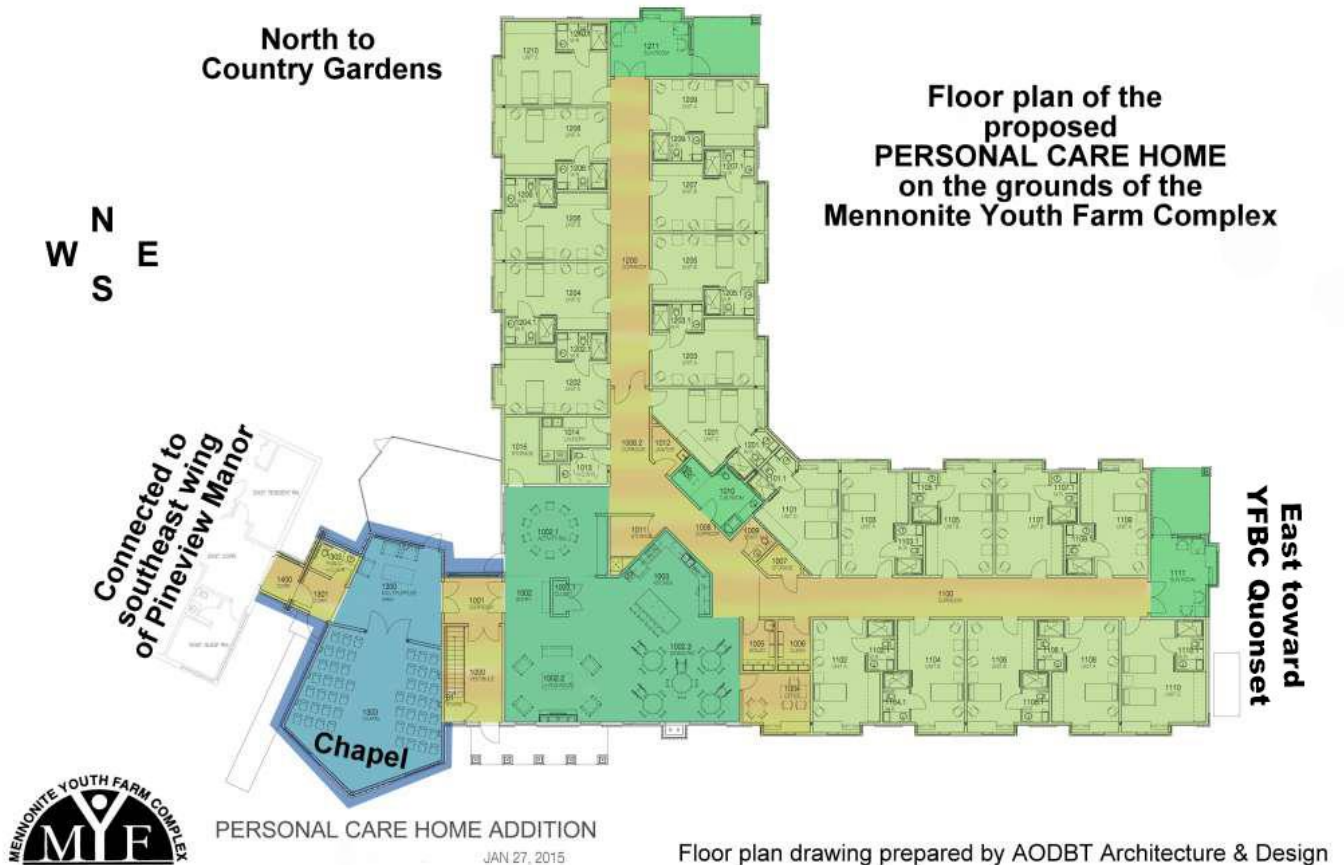

Below is the Floor Plan:



Have fun watching things continually changing.